

## Instruction of Natesto Nasal Gel

Before the first use, while at the sink, hold the Natesto Nasal Gel upside down. Slowly press and release the pump 10 times. Wash off any gel released during this process. Finally, wipe the hole and tip with a clean and dry tissue.

1. Blow your nose before application. Remove the cap from the dispenser.
2. Using a mirror, place your right index finger on the pump of the dispenser. Slowly insert the tip of the dispenser into the left nostril until the finger on the pump touches the bottom of the nose.
3. Tilt the dispenser slightly so that the hole at the tip contacts the inner wall of the nostril. Slowly press the pump until it stops.
4. While wiping along the inner wall, remove the dispenser from the nostril to ensure all gel remains inside.
5. Repeat the above steps in the right nostril (from Step 2).
6. After administering in both nostrils, clean the hole and tip with a clean and dry tissue. Replace the cap.
7. Press and massage the area just below the middle of the nose bridge to bring both nostrils close together. Avoid blowing your nose or inhaling forcefully through your nose within 1 hour after use.

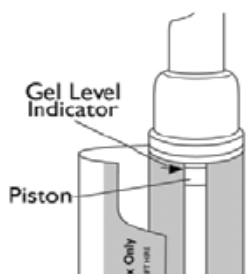
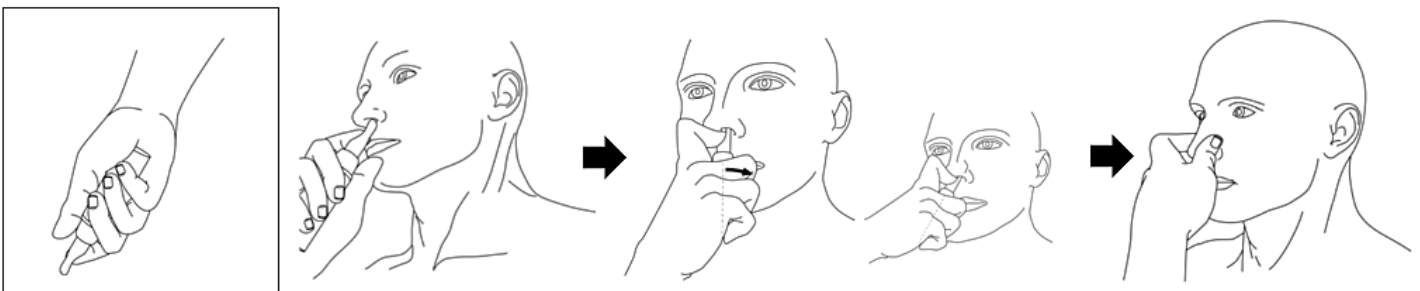
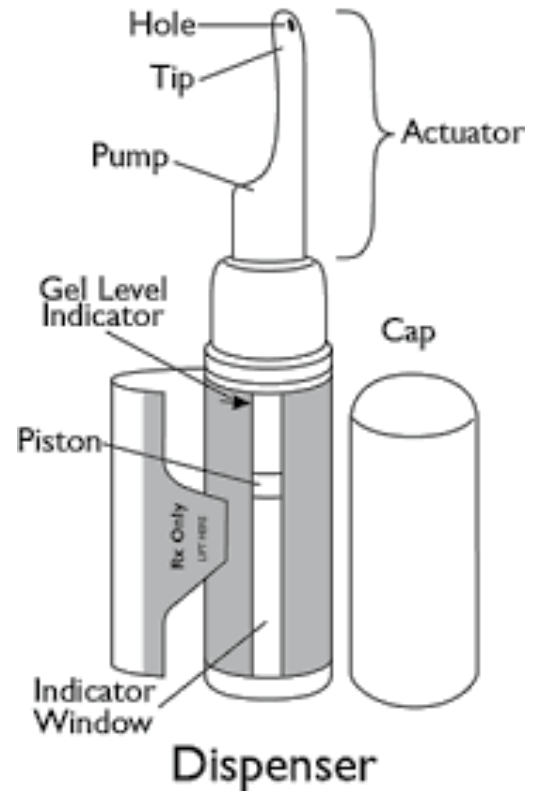

When the top of the piston inside the dispenser reaches the arrow at the top of the inner label, use a new Dispenser. The gel level indicator can be seen when the label around the container is opened.

